

TimeTec Smart License Plate Recognition System

Securely Automate Vehicle Access



TimeTec Smart License Plate Recognition LPR or ANPR (Automatic Number Plate Recognition) is an ultramodern technology that incorporates Optical Character Recognition (OCR) technology and LPR camera to convert a scanned image into a readable alphanumeric text at greatest accuracy. The system is designed to be standalone and it is also made integratable with cloud-based TimeTec Visitor Management System (VMS), TimeTec Access, TimeTec Parking and i-Neighbour Smart Community System to ease entry and exit of vehicles into and from an enclave.

Pre-register authorized plate numbers into the system and when any of the registered cars approaching a security barrier installed with TimeTec solution, the barrier will open automatically and the system will record each audit trail of the access activity.

TimeTec Smart LPR System is also formulated to capture visitors' vehicle number plates as an additional visitor information for extra security measure for a neighbourhood or an office building.

TimeTec Smart LPR System automates vehicle access, improves security and provides utmost convenience without compromising your sanctuary.



Embedded with deep learning technology that constantly improves the accuracy



Reliability Rate at 98%.



Processing time of 100ms
(Based 15 processor, 4GB RAM on Windows 7, 8 or 10)



Offer 2-line Plate Recognition



Reliability is assured for each character and plate



Reading from memory, BMP or JPG formats



Hardware independent (cameras, frame-grabbers, and etc.)



Instant integration with IP cameras (5MP resolution, ONVIF compliant)



Effective distance at 1.2m. Integrate with loop detector for better performance



Extreme perspective correction



Shorten vehicle access processing time



Enhance effectiveness of existing security system



Efficient and convenient post-event analysis





Compatible with i-Neighbour, TimeTec VMS & TimeTec Access

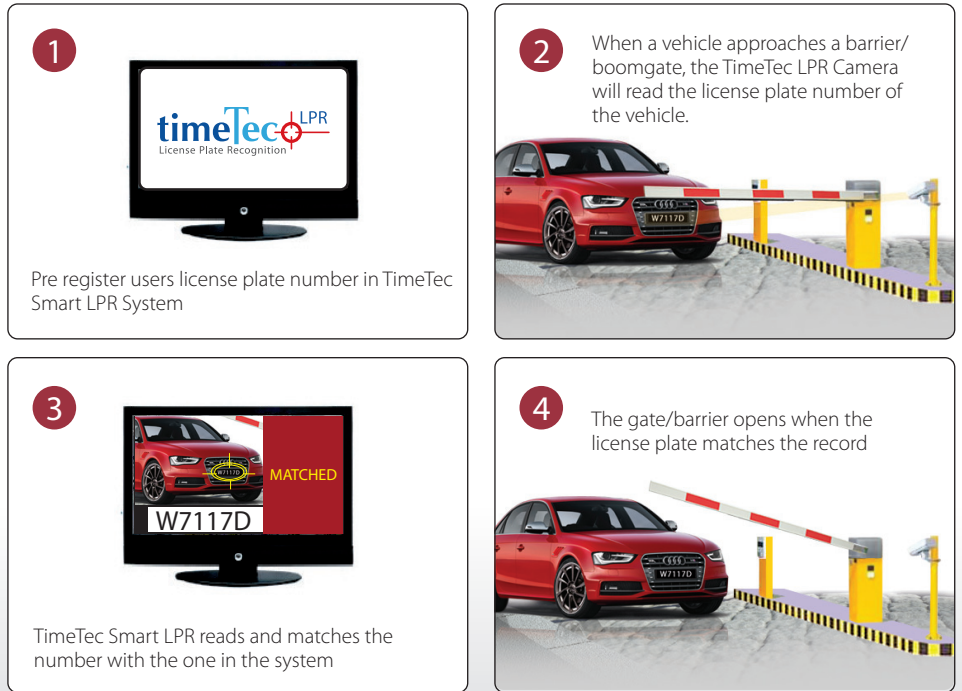

THE FLOW OF TIMETEC LPR SYSTEM

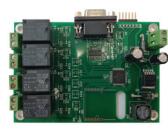

TIMETEC LPR PACKAGE

ITEM	TECHNICAL SPECIFICATION
<p>2 x LPR Camera for entry and exit</p> <div style="text-align: center;">  </div>	<p>ITC215-PW4I-IRLZF27135</p> <ul style="list-style-type: none"> 2 Megapixel Full HD AI Access LPR Camera 1/2.8 inch 2Megapixel Progressive scan CMOS WDR, Day/Night(ICR), 3DNR,BLC, HLC H.265& H.264 dual-stream encoding Powerful 2.7-13.5mm motorized lens and IR light, ideal for monitor LPR distance 3-8m IP67, and superior performance for outdoor applications
<p>2 X LED Panel</p> <div style="text-align: center;">  </div>	<p>32x16 Dot Matrix LED</p> <ul style="list-style-type: none"> Communication : RS 232 Display data : ASCII characters Display dimension : 320 mm x 160 mm Display resolution : 32 x 16 pixel Font size : 70 mm x 50 mm Display style : 1 line rolling or 2 lines static
<p>1x Computer</p> <div style="text-align: center;">  </div>	<ul style="list-style-type: none"> CPU : Core i5 Intel, minimum 3.0 GHz RAM : 4GB or above Network : Ethernet 100Mbit Graphic adapter : AGP or PCI-Express, minimum 1024 x 768, 16-bit colors Hard disc : E-IDE, PATA, SATA, SCSI, SAS (7200 RPM or faster) Hard disc space : Minimum 10 GB free hard disk space available, excluding space needed for recordings OS : Microsoft® Windows® 10 Professional (64-bit) Microsoft® Windows® 8.1 Enterprise (64-bit) Microsoft® Windows® 8.1 Pro (64-bit) USB port : Min 2 (one to connect to LPR gate relay board) Serial ports : Min 2 (each connect to LED panel)
<p>1 x LPR Gate Relay Board</p> <div style="text-align: center;">  </div>	<ul style="list-style-type: none"> Power input : 12VDC 3A Output : 2 x FORM C relay
<p>Software</p>	<p>TimeTec iSense</p>

NOTE: Specifications are subject to change without prior notice.